

# TRX—TORQUE TRANSDUCER



## FEATURES

- Ratings 100—2000Nm
- Sealed to IP67.
- Accuracy  $\pm 0.06\%$  FS.

## APPLICATIONS

- Test Machines
- Process Control.

## DESCRIPTION

The TQ-TRX provides a flange design device for measuring torsion. The TRX is produced from stainless steel construction and has a fully welded construction.

The load cell has been designed for test rig applications where static and dynamic measurement is required.

## TYPICAL SPECIFICATION

PARAMETER	VALUE	UNITS
<b>Static Torque</b>	0.. 100, 250, 500, 1000, 2000	Nm
<b>Rated Output</b>	1 $\pm 0.1\%$	mV/V
<b>Linearity &amp; Hysteresis</b>	0.06	$\pm\%$ of Rated Output
<b>Zero Return after 30 minutes</b>	0.03	$\pm\%$ of Applied Load
<b>Zero Balance</b>	$\pm 0.5$	%
<b>Temperature Range: Operating</b> <b>Temperature Range: Compensated</b>	-10 to +70 0 to +60	$^{\circ}\text{C}$
<b>Temperature Effect: On Output</b> <b>Temperature Effect: On zero</b>	0.01 0.02	$\pm\%$ of FS $\pm\%$ of FS
<b>Safe Overload</b>	120	% of Rated Capacity
<b>Ultimate Overload</b>	300	% of Rated Capacity
<b>Excitation: Recommended</b> <b>Excitation: Maximum</b>	10 15	Volts DC
<b>Input Resistance</b>	700 nom	Ohms
<b>Output Resistance</b>	700 nom	Ohms
<b>Insulation Resistance</b>	>2	G $\Omega$ at 50VDC
<b>Deflection at Rated Capacity</b>	NA	mm
<b>Weight (approximate) :</b>	NA	kg
<b>Construction</b>	Stainless Steel	
<b>Environmental Protection</b>	IP67	
<b>Cable</b>	5m 4 core screened	

# TRX—TORQUE TRANSDUCER

## OUTLINE DIMENSIONS in millimeters

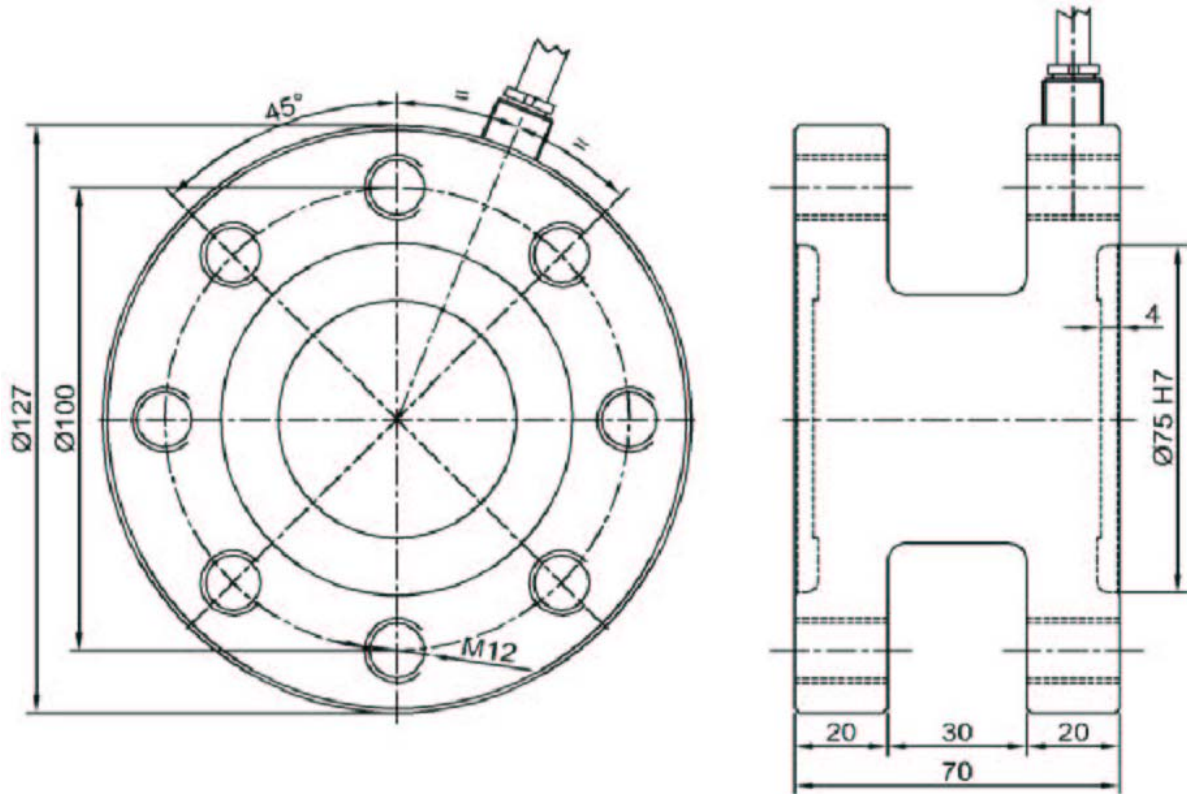

STATIC NOMINAL LOAD	100 Nm	200 Nm	500 Nm	1000 Nm	2000 Nm
max axial permissible load	20 kN	40 kN	80 kN	150 kN	200 kN
breaking axial load	2 kN	4 kN	8 kN	15 kN	20 kN

### FIXING SCREWS

- A) DIAMETER M12
- B) GRADE 12.9
- C) TIGHTENING TORQUE 140Nm

NOTE: If the dimensions or specification do not suit, PCM have an in-house design and build service that should satisfy your requirements.

## WIRING DETAIL

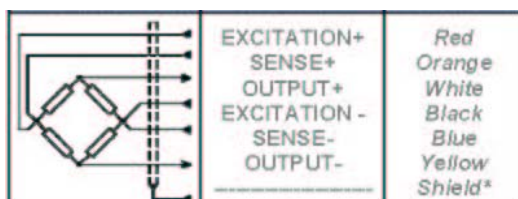

## LOADING MODE

