

TCA—Bi-Directional Load Cell

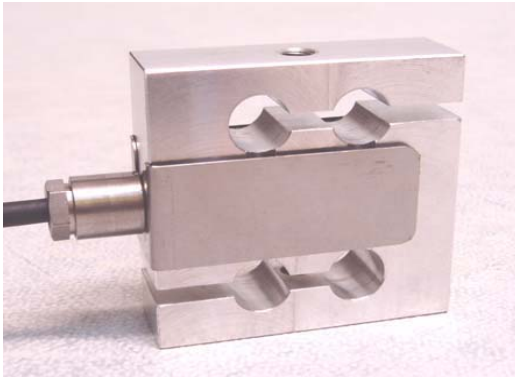

FEATURES

- Capacities 0..1Kg—50Kg
- Sealed to IP20.
- Tension & Compression use.
- Single wheatstone bridge.

APPLICATIONS

- Test Machines
- Restricted height constraint.
- Virtually all industries.

DESCRIPTION

The TCA is a low profile S-Type design load cell produced from aluminium material. Used for both tension and compression applications.

The TCA is a standard design load cell.

TYPICAL SPECIFICATION

PARAMETER	VALUE	UNITS
Capacities Range	0.. 1, 2, 5, 10, 25, 50.	kg
Rated Output	2.0 nominal	mV/V
Linearity & non repeatability	0.06	±% of Rated Output
Zero Return after 30 minutes	0.025	±% of Applied Load
Zero Balance	1.0	±% of Rated Output
Temperature Range: Operating	-20 to +70	°C
Temperature Range: Compensated	-10 to +40	
Temperature Effect: On Output	0.0021	±% of Rated Output/°C
Temperature Effect: On zero	0.0025	±% of Rated Load/°C
Safe Overload	150	% of Rated Capacity
Ultimate Overload	300	% of Rated Capacity
Excitation: Recommended	10	Volts AC or DC
Excitation: Maximum	18	
Input Impedance	440 nominal	ohm
Output Impedance	350 nominal	ohm
Insulation Resistance	>5	GΩ at 50VDC
Deflection at Rated Capacity	0.3	mm
Weight (approximate) :	0.3	kg
Construction	Aluminium	
Environmental Protection	IP20	
Cable	3m PVC Core screened	

TCA—Bi-Directional Load Cell

OUTLINE DIMENSIONS in millimeters

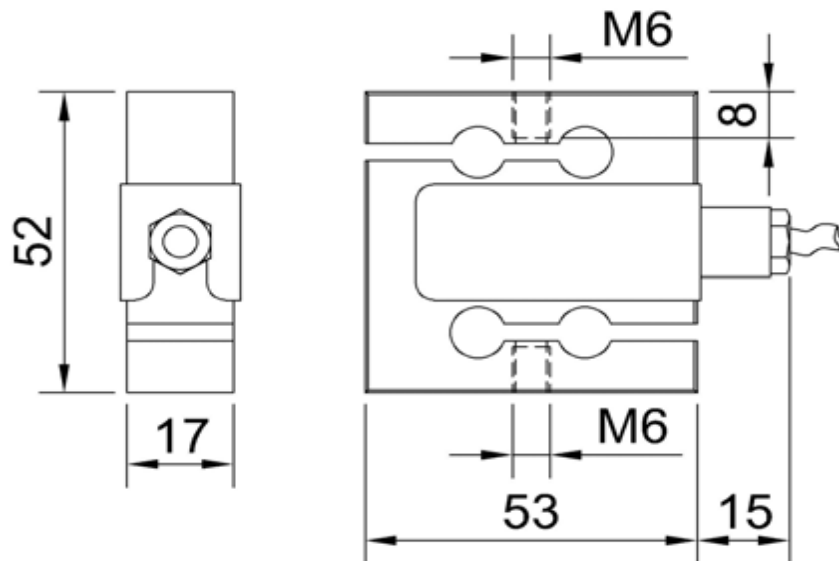

NOTE: If the dimensions or specification do not suit, PCM have an in-house design and build service that should satisfy your requirements.

WIRING DETAIL

LOADING MODE

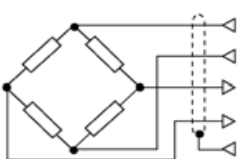
Dynamometer	OUTPUT	CABLE
	EXCITATION+ EXCITATION - OUTPUT+ OUTPUT- -----	<i>Red</i> <i>Black</i> <i>White</i> <i>Yellow</i> Shield*

