

SLP—Shackle Load Pin—Custom



FEATURES

- Capacities 5—100Te
- Sealed to IP67.
- Stainless Steel.
- Single or dual bridges.

APPLICATIONS

- In line Weighing.
- Heavy Industry.
- Towing/Mooring tension.
- Cable tension monitoring.

DESCRIPTION

The T-SLP provides a simple device for tension measurement. The unit is designed around the Crosby G2130 'Bow' body shackle. The anti-rotation plate, nut and centralising bobbin are included within the package. If the bow shackle sizes are not listed to your requirements PCM can custom build to suit your shackle design.

As with all PCM's load cells and pins they can be set up with a range of standard or special instrumentation packages, including radio telemetry. The load pin with or without instruments can be supplied with full calibration using a BS EN ISO 7500-1 test machine traceable to national standards.

TYPICAL SPECIFICATION

PARAMETER	VALUE	UNITS
Capacities Range	0.. 0.5, 2, 5, 10, 15, 25, 35, 50, 100	Te
Rated Output	1 - 2 Nominal	mV/V
Linearity & non repeatability	0.25 - 2	±% of Rated Output
Zero Return after 30 minutes	0.2	±% of Applied Load
Zero Balance	1.5	±% of Rated Output
Temperature Range: Operating	-10 to +80	°C
Temperature Range: Compensated	Amb to +70	
Temperature Effect: On Output	0.1	±% of Rated Output/°C
Temperature Effect: On zero	0.02	±% of Rated Load/°C
Safe Overload	200	% of Rated Capacity
Ultimate Overload	500	% of Rated Capacity
Excitation: Recommended	10	Volts AC or DC
Excitation: Maximum	15	
Input Impedance	380 nominal	ohm
Output Impedance	350 nominal	ohm
Insulation Resistance	>2	GΩ at 50VDC
Deflection at Rated Capacity	NA	mm
Weight (approximate) :	NA	kg
Construction	Stainless Steel	
Environmental Protection	IP67	
Cable	5m 7/0.2 4 core screened	

SLP—Shackle Load Pin—Custom

OUTLINE DIMENSIONS in millimetres

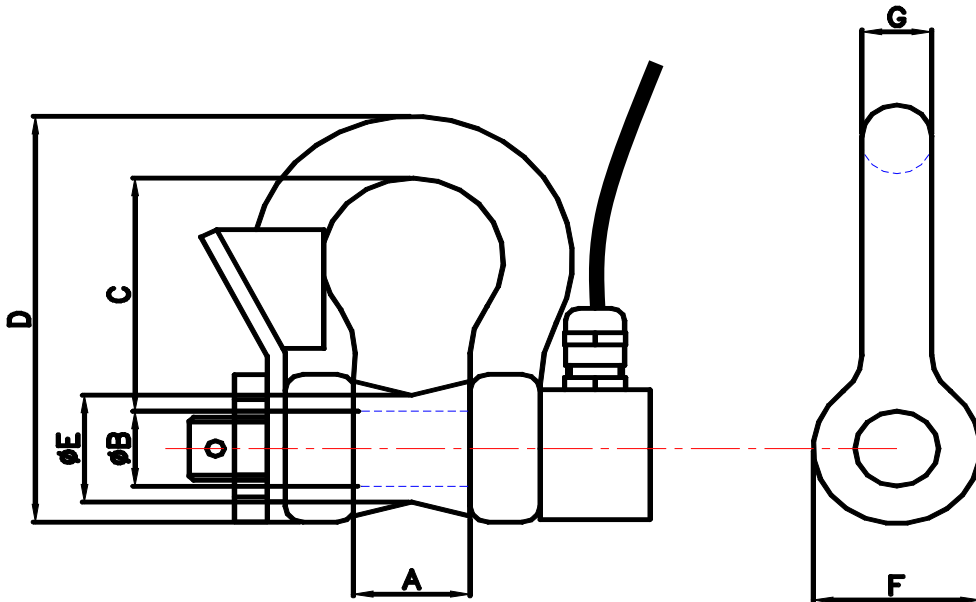

SHACKLE PIN (Te)	G2130 SHACKLE	A	ØB	C	D	ØE	F	G	NOMINAL WEIGHT(KG)
0.5	3.25Te	26.9	19.1	60.5	106	30.3	38.1	16	0.76
2	3.25Te	26.9	19.1	60.5	106	30.3	38.1	16	0.76
5	6.5Te	36.6	25.4	84	148	36.6	53	22.4	1.79
10	12Te	51.5	35.1	119	210	52.6	76	31.8	5.31
25	25Te	73	51	178	313	72.7	106	44.5	15.4
35	35Te	82.5	57	197	348	79.4	122	51	23.7
50	55Te	105	70	267	453	91.9	145	66.5	44.6
75	85Te	127	82.5	330	546	115	165	76	70
100	120Te	133	95.5	372	626	127	203	92	120

NOTE: If the dimensions or specification do not suit, PCM have an in-house design and build service that should satisfy your requirements.

WIRING DETAIL

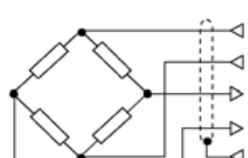
Dynamometer	OUTPUT	CABLE
	EXCITATION+ EXCITATION - OUTPUT+ OUTPUT-	Red Blue Yellow Green Shield

LOADING MODE

