

250—Miniature Load Cell

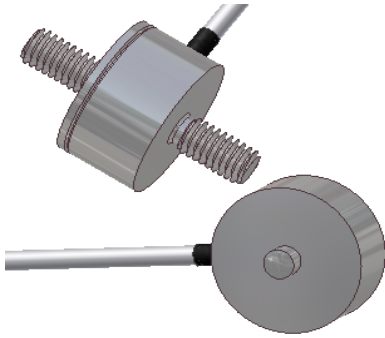

FEATURES

- Stainless Steel Construction
- Sealed to IP65.
- Simple to install

APPLICATIONS

- Research & Development.
- Restricted areas.
- Static and Dynamic tests.
- Test Rigs.

DESCRIPTION

The 250 Miniature design load cell is produced from stainless steel. Its low profile design allows it to be used in restricted height applications. If the capacities or dimensions do not suit your requirement, PCM's in house design and build service may be able to satisfy your requirements.

TYPICAL SPECIFICATION

PARAMETER	VALUE	UNITS
Capacities Range	0.. 100, 200, 400, 800	N
Rated Output	1.6 nominal	mV/V
Linearity & non repeatability	0.5	±% of Rated Load
Hysteresis	0.5	±% of Rated Load
Repeatability	0.1	±% of Rated Load
Zero Return after 30 minutes	0.01	±% of Applied Load
Zero Balance	4.0	±% of Rated Output
Temperature Range: Operating	-30 to +80	°C
Temperature Range: Compensated	-10 to +50	
Temperature Effect: On Output	0.005	±% of Applied Load/°C
Temperature Effect: On zero	0.03	±% of Rated Output/°C
Safe Overload	150	% of Rated Capacity
Ultimate Overload	200	% of Rated Capacity
Excitation: Recommended	5	Volts AC or DC
Excitation: Maximum	10	
Input Impedance	350 nominal	ohm
Output Impedance	350 nominal	ohm
Insulation Resistance	>2	GΩ at 50VDC
Deflection at Rated Capacity	>0.5	mm
Weight (approximate) :	NA	kg
Construction	Stainless Steel	
Environmental Protection	IP65	
Cable	2m 4 core screened	screen not connected to load cell

MODEL: BD-250-MS



250—Miniature Load Cell

OUTLINE DIMENSIONS in millimeters

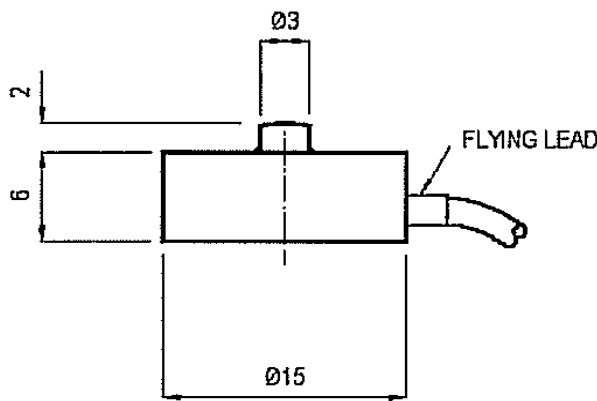

**LOADBUTTON VERSION
COMPRESSION ONLY**

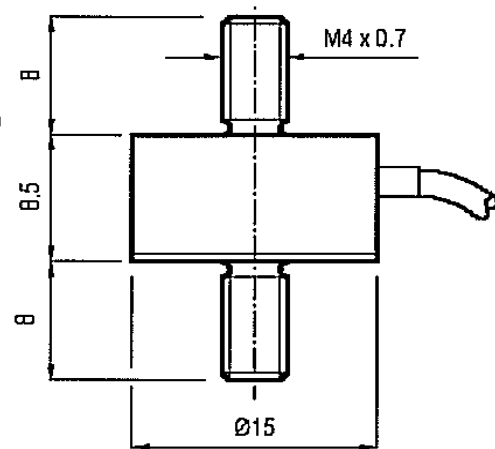

**STUD VERSION
TENSION AND/OR COMPRESSION**

NOTE: If the dimensions or specification do not suit, PCM have an in-house design and build service that should satisfy your requirements.

WIRING DETAIL

Dynamometer	OUTPUT	CABLE
	EXCITATION+ EXCITATION - OUTPUT+ OUTPUT- -----	Red Blue Yellow Green Shield*

LOADING MODE

