

CM—Compression Load Cell

FEATURES



- Capacities 100—2500Kg
- Sealed to IP67.
- Compression use.
- Linearity & repeatability $\pm 0.25\%$ FS.

APPLICATIONS

- Test Machines
- Process Control.
- Miniature weighing projects.
- Harsh environments.

DESCRIPTION

The C-CM provides a single measuring device for compression measurement. The CM is produced from stainless steel construction and has an IP rating of IP67.

The load cell has been designed for test rig applications

TYPICAL SPECIFICATION

PARAMETER	VALUE	UNITS
Capacities Range	0.. 100, 250, 500, 1000, 2500	Kg
Rated Output	2.0 nom	mV/V
Linearity & non repeatability	0.25	$\pm\%$ of Full Scale
Zero Return after 30 minutes	0.05	$\pm\%$ of Applied Load
Zero Balance	1.0	$\pm\%$ of Full Scale
Temperature Range: Operating	-20 to +70	°C
Temperature Range: Compensated	-10 to +40	
Temperature Effect: On Output	0.025	$\pm\%$ of Full Scale
Temperature Effect: On zero	0.03	
Safe Overload	150	% of Rated Capacity
Ultimate Overload	300	% of Rated Capacity
Excitation: Recommended	10	Volts AC or DC
Excitation: Maximum	15	
Input Impedance	400 nominal	ohm
Output Impedance	350 nominal	ohm
Insulation Resistance	>2	G Ω at 50VDC
Deflection at Rated Capacity	NA	mm
Weight (approximate) :	0.3	kg
Construction	Stainless Steel	
Environmental Protection	IP67	
Cable	3m 4 core screened	

CM—Compression Load Cell

OUTLINE DIMENSIONS in millimeters

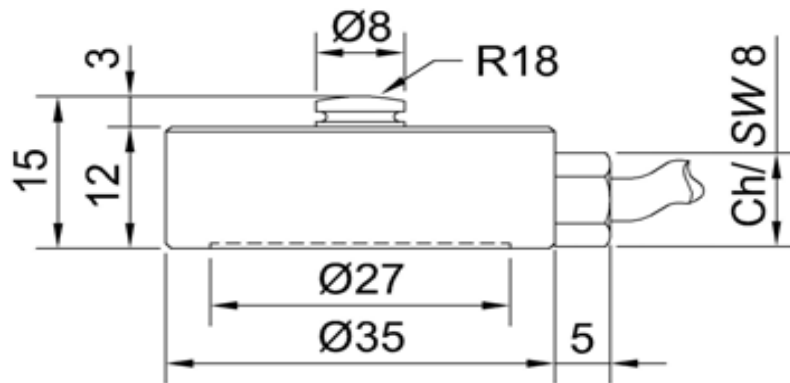

NOTE: If the dimensions or specification do not suit, PCM have an in-house design and build service that should satisfy your requirements.

WIRING DETAIL

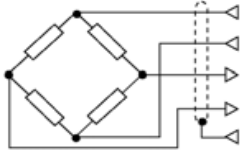
Dynamometer	OUTPUT	CABLE
	EXCITATION+ EXCITATION - OUTPUT+ OUTPUT- -----	<i>Red</i> <i>Black</i> <i>White</i> <i>Yellow</i> <i>Shield*</i>

LOADING MODE

