

# FORCE WASHER—Compression Load Cell



## FEATURES

- Capacities 500—2500Kg
- Sealed to IP54.
- Accuracy 1% RO.
- Custom build dimensions available.

## APPLICATIONS

- Heavy Duty Weighing.
- Rolling Mills.
- Monitoring bolt up forces.
- Test rigs.

## DESCRIPTION

The C-FW is a compact bobbin style design load cell produced from aluminium & stainless steel. PCM can supply an optional hardened washer for bolt torque monitoring projects. If the capacities or dimensions do not suit your requirements, PCM's in-house design and build service may be able to satisfy your requirements.

The units are supplied with calibration certificates using a BS EN ISO 7500-1 test machine traceable to National Standards.

## TYPICAL SPECIFICATION

PARAMETER	VALUE	UNITS
Capacities Range	0.. 500, 1000, 2000, 5000, 10000, 25000.	Kg
Rated Output	2.0 nominal	mV/V
Linearity & non repeatability	1.0	±% of Rated Output
Zero Return after 30 minutes	0.05	±% of Applied Load
Zero Balance	1.0	±% of Rated Output
Temperature Range: Operating	-30 to +80	°C
Temperature Range: Compensated	-10 to +70	
Temperature Effect: On Output	0.1	±% of Applied Load/°C
Temperature Effect: On zero	0.02	±% of Rated Output/°C
Safe Overload	150	% of Rated Capacity
Ultimate Overload	300	% of Rated Capacity
Excitation: Recommended	10	Volts AC or DC
Excitation: Maximum	15	
Input Impedance	700 nominal	ohm
Output Impedance	700 nominal	ohm
Insulation Resistance	>2	GΩ at 50VDC
Deflection at Rated Capacity	NA	mm
Weight (approximate) :	NA	kg
Construction	<1Te Aluminium. >1Te Stainless Steel	
Environmental Protection	IP54	
Cable	5m 4 core screened	7/0.1-PVC Sheath

MODEL: C-FW



# FORCE WASHER—Compression Load Cell

OUTLINE DIMENSIONS in millimeters

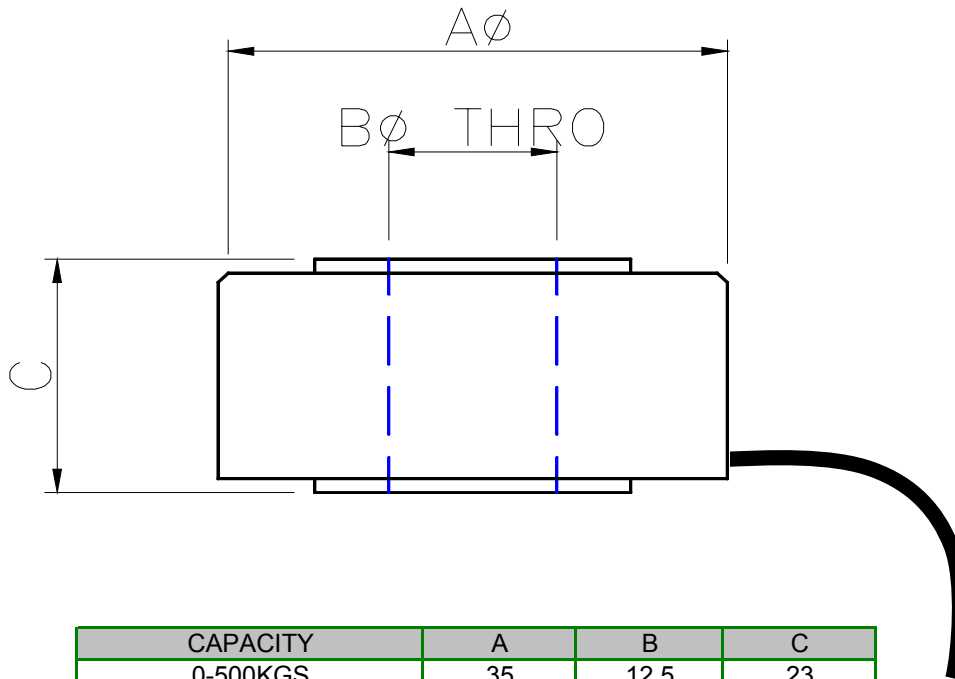

CAPACITY	A	B	C
0-500KGS	35	12.5	23
0-1000KGS	35	12.5	23
0-2000KGS	35	12.5	23
0-5000KGS	35	12.5	23
0-10000KGS	50	22	23
0-25000KGS	50	22	23

NOTE: If the dimensions or specification do not suit, PCM have an in-house design and build service that should satisfy your requirements.

## WIRING DETAIL

Dynamometer	OUTPUT	CABLE
	EXCITATION+	Red
	EXCITATION -	Blue
	OUTPUT+	Green
	OUTPUT-	Yellow
	-----	Shield*

## LOADING MODE

