

ANNULAR—Compression Load Cell



FEATURES

- Capacities 15Te—200Te
- Sealed to IP54.
- Accuracy 0.5-1% RO.
- Custom build dimensions available.

APPLICATIONS

- Heavy Duty Weighing.
- Rolling Mills.
- Monitoring bolt up forces.
- Test rigs.

DESCRIPTION

The C-A is a large bobbin style design load cell produced from aluminium & stainless steel (depending on capacity). The outer cover is manufactured from a toughened plastic to reduce the overall weight. PCM can supply an optional hardened washer for bolt torque monitoring projects. If the capacities or dimensions do not suit your requirements, PCM's in-house design and build service may be able to satisfy your requirements. The units are supplied with calibration certificates using a BS EN ISO 7500-1 test machine traceable to National Standards.

TYPICAL SPECIFICATION

PARAMETER	VALUE	UNITS
Capacities Range	0.. 15, 20, 30, 50, 100, 200.	Te
Rated Output	2.0 nominal	mV/V
Linearity & non repeatability	0.5 (100 & 200Te 1%)	±% of Rated Output
Zero Return after 30 minutes	0.05	±% of Applied Load
Zero Balance	1.0	±% of Rated Output
Temperature Range: Operating	-30 to +80	°C
Temperature Range: Compensated	-10 to +70	
Temperature Effect: On Output	0.1	±% of Applied Load/°C
Temperature Effect: On zero	0.02	±% of Rated Output/°C
Safe Overload	150	% of Rated Capacity
Ultimate Overload	300	% of Rated Capacity
Excitation: Recommended	10	Volts AC or DC
Excitation: Maximum	15	
Input Impedance	700 nominal	ohm
Output Impedance	700 nominal	ohm
Insulation Resistance	>2	GΩ at 50VDC
Deflection at Rated Capacity	NA	mm
Weight (approximate) :	NA	kg
Construction	15-20Te Alum. 30Te + S/Steel	
Environmental Protection	IP54	
Cable	5m 4 core screened	7/0.2-Poly Sheath

MODEL: C-A



Procter & Chester Measurements

ANNULAR—Compression Load Cell

OUTLINE DIMENSIONS in millimeters

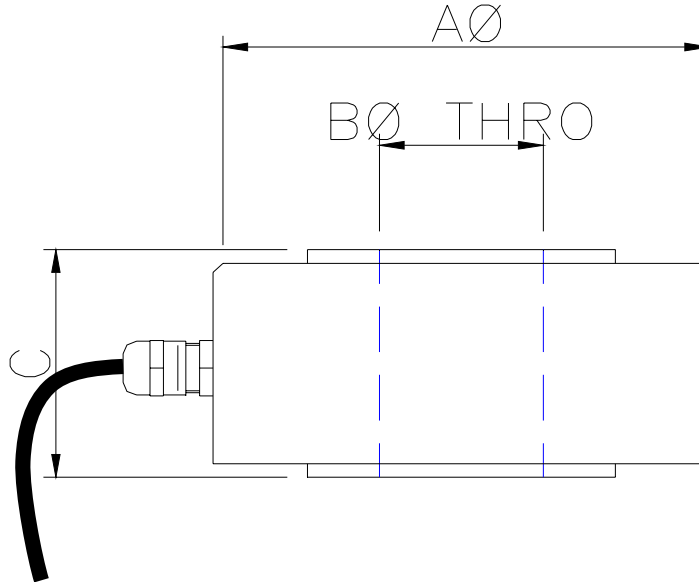

CAPACITY	A	B	C
0-15TE	154	95	180
0-20TE	154	95	180
0-30TE	154	95	180
0-50TE	154	95	180
0-100TE	154	95	180
0-200TE	154	95	180

NOTE: If the dimensions or specification do not suit, PCM have an in-house design and build service that should satisfy your requirements.

WIRING DETAIL

Dynamometer	OUTPUT	CABLE
	EXCITATION+ EXCITATION - OUTPUT+ OUTPUT-	Red Blue Green Yellow Shield*

LOADING MODE

