

Shackle Load Pins

Shear Pin Series

5Te – 100Te



FEATURES

- Stainless steel construction.
- Rugged load cell design.
- Sealed to IP67.
- Simple to install.
- Both internal and external designs available.
- Manufacture to order. One off's and quantity.
- Fitted with anti-rotation bracket, nut and locating bobbin.
- Custom build available to suit your shackle design.

APPLICATIONS

- Lifting protection.
- Gantry / over head cranes.
- Test Rigs
- Pull Tests.
- Dead ends of a rope for a winch or crane.

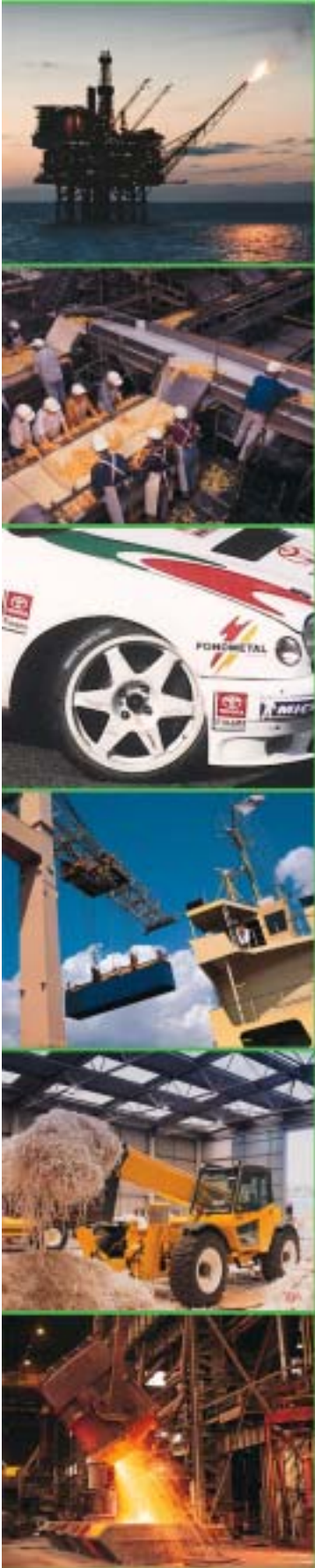

PARAMETER		UNITS
Rated Capacities	5, 10, 15, 17, 25, 50, 100	TE
Rated Output	1-2 nominal	MV/V
Linearity + non repeatability	0.25-2	±% of Rated Output
Zero Return after 30 minutes	0.2	±% of Applied Load
Zero Balance	1.5	±% of Rated Output
Temperature Range: Operating Temperature Range: Compensated	-10 to +80 -10 to +60	°C
Temperature Effect: On Output Temperature Effect: On zero	0.1 0.02	±% of Applied Load/°C ±% of Rated Load/°C
Safe Overload	200	% of Rated Capacity
Ultimate Overload	500	% of Rated Capacity
Excitation: Recommended Excitation: Maximum	10 15	Volts AC or DC
Input Impedance	380 nominal	ohm
Output Impedance	350 nominal	ohm
Insulation Impedance	>2000	megaohm
Deflection at Rated Capacity	NA	mm
Weight (approximate) :	NA	kg
Construction	Stainless steel	
Environmental Protection	IP67	
Cable	10m 4 core screened	
Connections – Produces a positive signal in compression.	Excitation + Red Excitation – Blue Signal + Yellow Signal – Green	The Screen is not connected to the load cell body.
	0505	

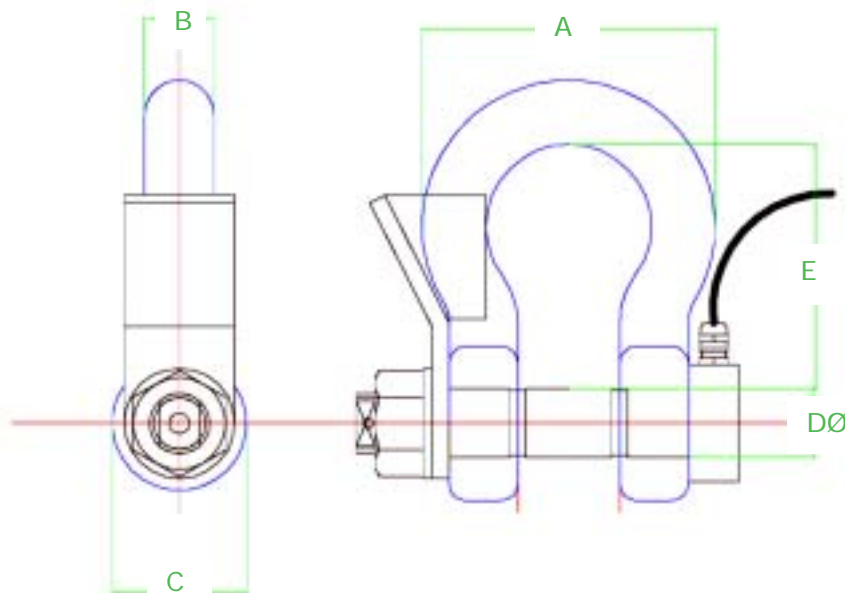

CAP.	A	B	C	D	E
	102	22.4	53	25.4	84
10TE	146	31.8	76	35.1	119
17TE	175	38.1	92	41.4	146
25TE	225	44.5	106	51.0	178
50TE	327	66.5	145	70.0	267
100TE	419	92	203	95.0	372

Dimensions in mm