



Bolt-on Sensor Over Load Protection



FEATURES

- Blacked tool steel construction.
- Rugged load cell design.
- Sealed to IP67.
- Simple to use.
- Custom build available

APPLICATIONS

- Overload load protection sensor.
- Protection device used on front end loaders.

(Not suitable for level measurement on silos).



Procter & Chester Measurements

PARAMETER		UNITS
Rated Capacities	±500	Micro-strain
Rated Output	1.5 nominal	MV/V
Linearity & Repeatability	1-3	±% of Rated Output
Zero Return after 30 minutes	0.15	±% of Applied Load
Zero Balance	1.5	±% of Rated Output
Temperature Range: Operating	-10 to +80	°C
Temperature Range: Compensated	-10 to +60	
Temperature Effect: On Output	0.1	±% of Applied Load/°C
Temperature Effect: On zero	0.1	±% of Rated Load/°C
Safe Overload	150	% of Rated Capacity
Ultimate Overload	300	% of Rated Capacity
Excitation: Recommended	10	Volts AC or DC
Excitation: Maximum	15	
Input Impedance	350 nominal	ohm
Output Impedance	350 nominal	ohm
Insulation Impedance	>2000	megaohm
Deflection at Rated Capacity	NA	mm
Weight (approximate) :	NA	kg
Construction	Blacked tool steel	
Environmental Protection	IP67	
Cable	4.5m 4 core screened	
Connections – Produces a positive signal in compression.	Excitation + Red Excitation – Blue Signal + Green Signal - Yellow	The Screen is not connected to the load cell body.
Document Revision Date	0505	

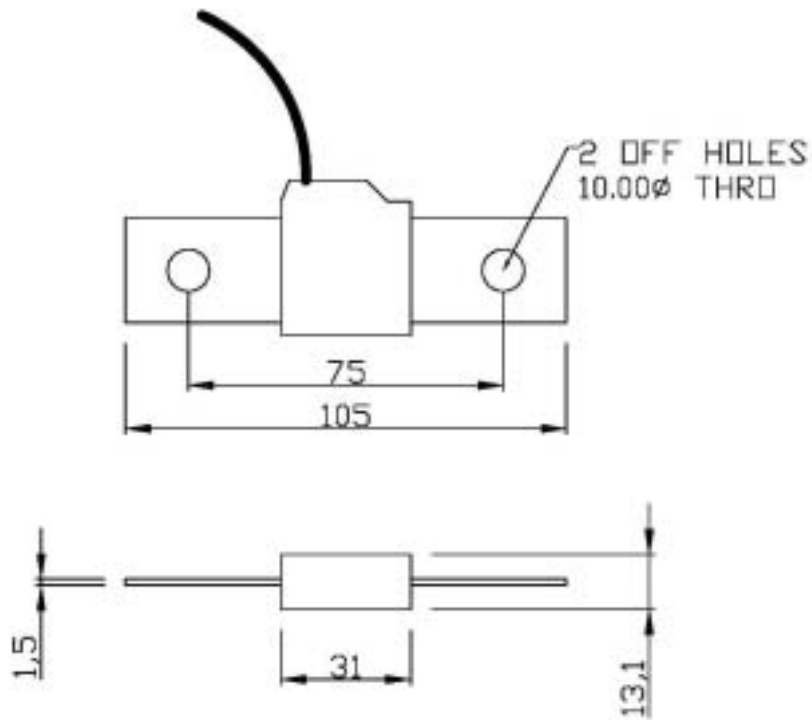

E100-054 shown.

Dimensions in mm

PCM produce custom design load cells, therefore we are able to modify the dimension and materials and build to order. PCM's policy is one of continuous improvement. We therefore reserve the right to incorporate technical modifications without prior notification. PCM are an approved ISO9001 manufacturer, Certificate No: 5527.