

Compression Load Cell

Miniature Button Series

100 – 800N

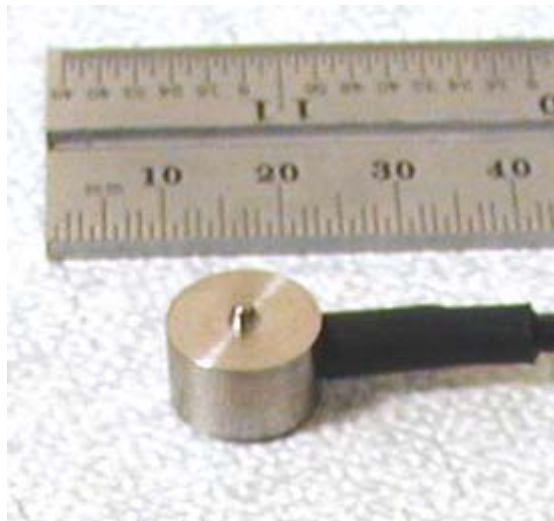

FEATURES

- Stainless steel construction
- 15mm outer diameter.
- Sealed to IP65.
- Simple to install.

APPLICATIONS

- Research & Development.
- Restricted areas.
- Static and dynamic tests
- Test Rigs.

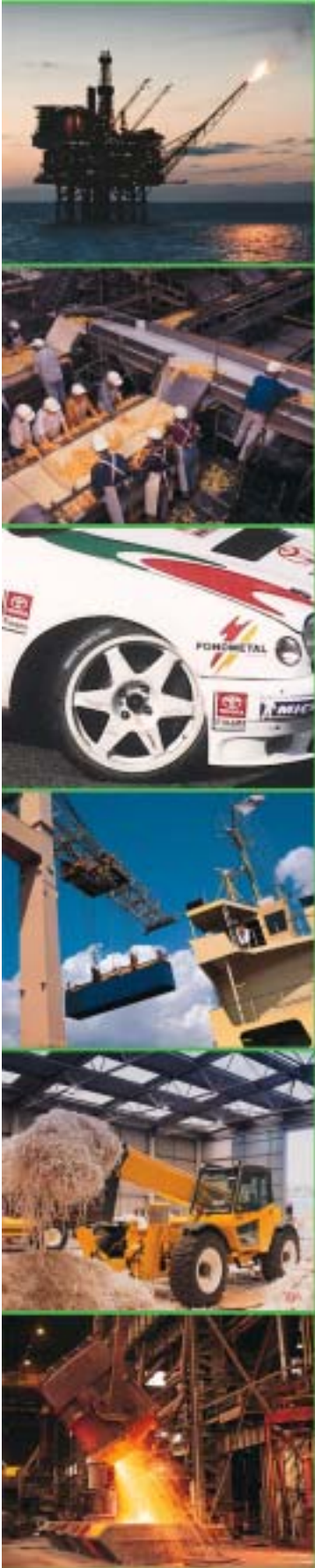



Procter & Chester Measurements

PARAMETER		UNITS
Rated Capacities	100, 200, 400, 800	N
Rated Output	1.6 nom	MV/V
Total Error	0.5	±% of Rated Output
Zero Return after 30 minutes	0.01	±% of Applied Load
Zero Balance	4	±% of Rated Output
Temperature Range: Operating	-30 to +80	°C
Temperature Range: Compensated	-10 to +50	
Temperature Effect: On Output	0.005	±% of Applied Load/°C
Temperature Effect: On zero	0.03	±% of Rated Load/°C
Safe Overload	150	% of Rated Capacity
Ultimate Overload	200	% of Rated Capacity
Excitation: Recommended	5	Volts AC or DC
Excitation: Maximum	10	
Input Impedance	350 nominal	ohm
Output Impedance	350 nominal	ohm
Insulation Impedance	>2000	megaohm
Deflection at Rated Capacity	<0.5	mm
Weight (approximate) :	NA	kg
Construction	Stainless Steel	
Environmental Protection	IP65	
Cable	2m 7/0.1 scr	
Connections – Produces a positive signal in compression.	Excitation + Red Excitation – Blue Signal + Yellow Signal – Green	The Screen is not connected to the load cell body.

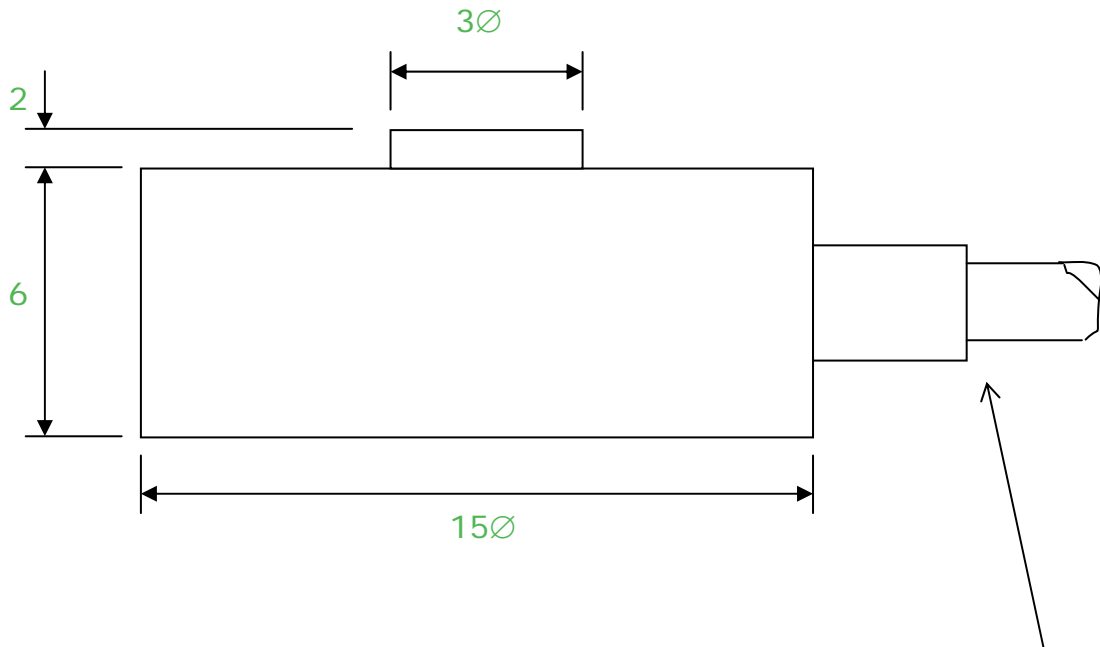

Dimensions in mm

Flying lead

Document Revision Date: 05/05

PCM produce custom design load cells, therefore we are able to modify the dimension and materials and build to order. PCM's policy is one of continuous improvement. We therefore reserve the right to incorporate technical modifications without prior notification. PCM are an approved ISO9001 manufacturer, Certificate No: 5527.