

## Compression Load Cell

### Force Washer Series

500Kg – 25000Kg



### FEATURES

- Robust stainless steel construction
- Rugged load cell design.
- Sealed to IP65.
- Simple to install.
- Custom build available.

### APPLICATIONS

- Heavy duty weighing.
- Rolling Mills.
- Industrial Platforms.
- Test Rigs.
- Monitoring bolt-up forces.

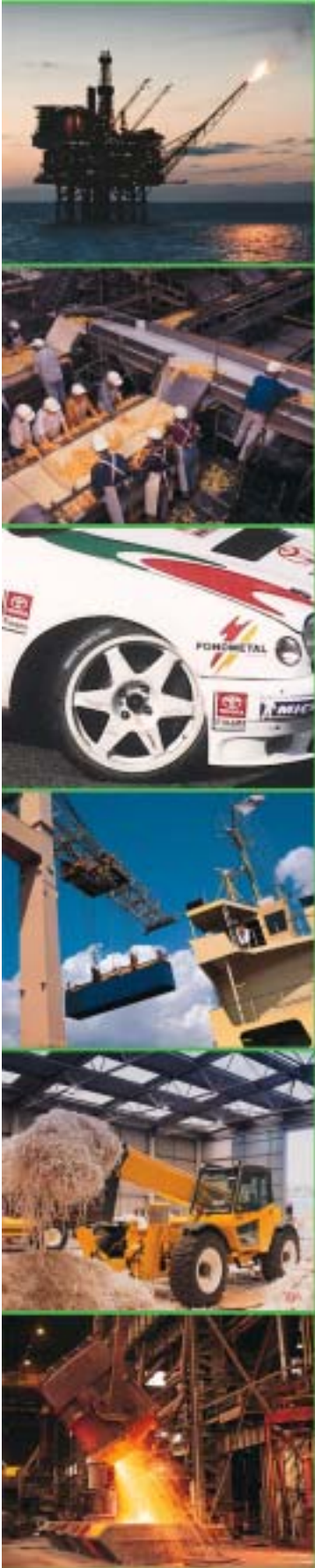



Procter & Chester Measurements

PARAMETER		UNITS
Rated Capacities	500 - 25000	Kg
Rated Output	1-2 nominal	MV/V
Linearity & repeatability	1-2	±% of Rated Output
Zero Return after 30 minutes	0.15	±% of Applied Load
Zero Balance	1.5	±% of Rated Output
Temperature Range: Operating	-10 to +80	°C
Temperature Range: Compensated	-10 to +60	
Temperature Effect: On Output	0.1	±% of Applied Load/°C
Temperature Effect: On zero	0.02	±% of Rated Load/°C
Safe Overload	150	% of Rated Capacity
Ultimate Overload	300	% of Rated Capacity
Excitation: Recommended	10	Volts AC or DC
Excitation: Maximum	15	
Input Impedance	700 nominal	ohm
Output Impedance	700 nominal	ohm
Insulation Impedance	>2000	megaohm
Deflection at Rated Capacity	NA	mm
Weight (approximate) :	NA	kg
Construction	Up to 1000Kg Aluminium >2000Kg 17-4ph Cond A S/Steel	
Environmental Protection	IP65	
Cable	5m 4 core screened	
Connections – Produces a positive signal in compression.	Excitation + Red Excitation – Blue Signal + Green Signal - Yellow	The Screen is not connected to the load cell body.
Document Revision Date	0505	

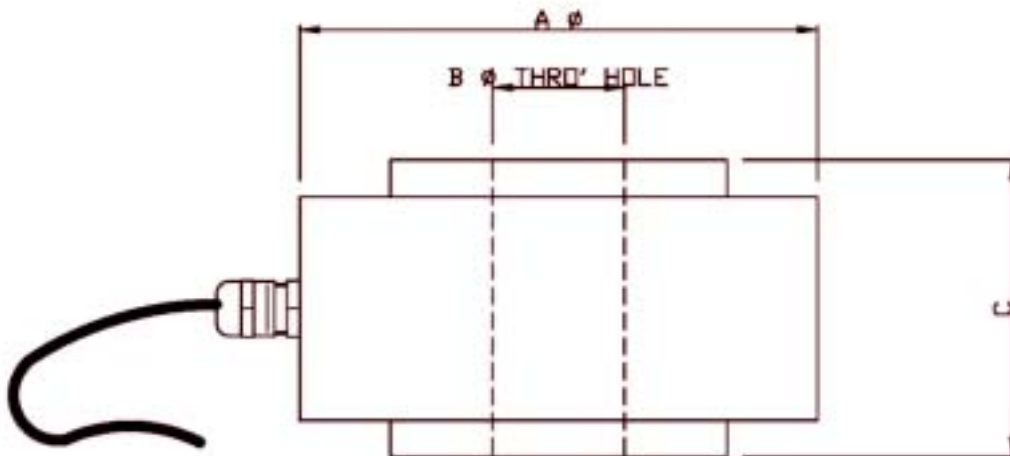

CAP.	A	B	C
0-500Kg	35	12.5	23
0-1000Kg	35	12.5	23
0-2000Kg	32	12.5	23
0-5000Kg	32	12.5	23
0-10000Kg	50.8	22	23
0-25000Kg	50.8	22	23

Dimensions in mm

PCM produce custom design load cells, therefore we are able to modify the dimension and materials and build to order. PCM's policy is one of continuous improvement. We therefore reserve the right to incorporate technical modifications without prior notification. PCM are an approved ISO9001 manufacturer, Certificate No: 5527.